

## 51.2V 102Ah Wall Mounted LiFePO4 Battery

Home Energy Storage Battery



6000 cycles  
at 80% DOD



1C/1C continual  
charge and discharge



Low voltage  
safety connection



WiFi Remote  
monitoring (optional)



Superior LiFePO4  
safety performance



5 years  
standard warranty

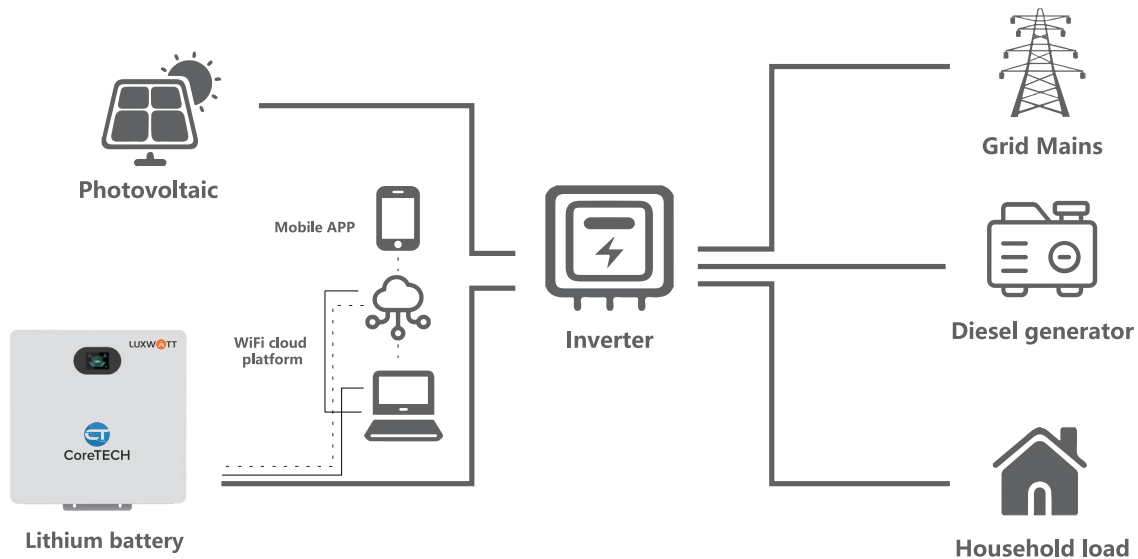

## Specification & parameter

Product Model	ES-BOX42
Rated Power	5.12kWh
Rated Voltage	51.2V
Suggested Working Voltage Range	44.8V~56.8V
Continual charge and discharge current	1C
Max. Charging/Discharging Current	100A
Rated Capacity	100Ah
Communication Method	USB/RS485/CAN
Working Temperature Range	Charging: 0~55 °C / Discharge: -20~55 °C
Working Humidity Range	5-85%RH
Discharge Depth	80-90%
Cycle Life	≥6000 80%DOD/0.2C/25±2 °C
Protection Grade	IP20
Overall Dimensions	485mm (L) * 480mm (W) * 155mm (H) (excluding hanging& wall brackets)
Display	3.2-inch touch screen
Net Weight	≤45KG
No. Of Parallel Connection	Supports 16PCS in parallel
Certification	ROHS/UN38.3/MSDS

WiFi/Bluetooth (Optional)